

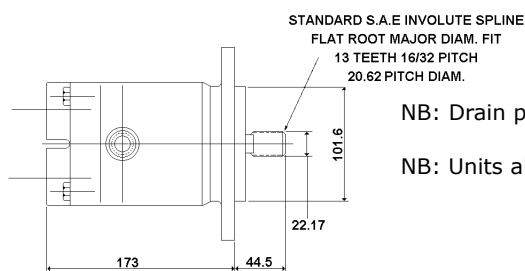

## FM Series

These units are designed for use as bi-rotational closed circuit transmission motors or as unidirectional open circuit pumps or motors.



NB: Drain port must be connected to tank

NB: Units also available with side ports

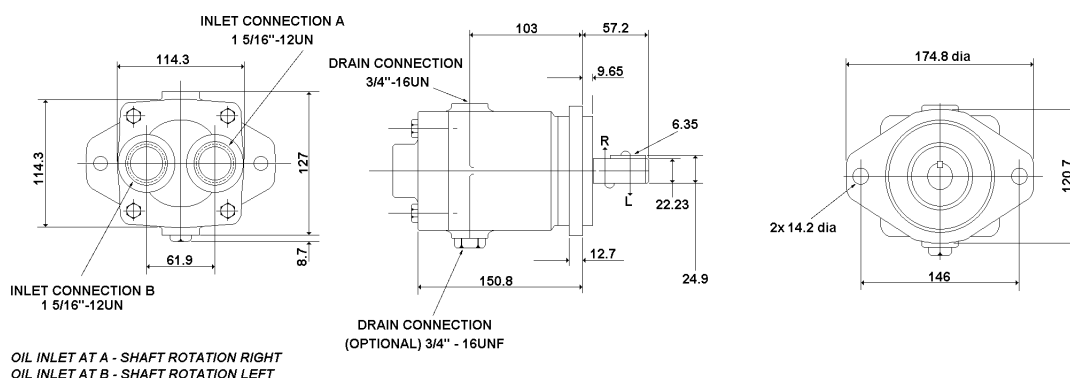

### PERFORMANCE DATA

SERIES	DISP CC/REV	CONT. PRESS BAR	INT. PRESS BAR	MAX SPEED AS PUMPS RPM		MAX. CASE PRESS BAR	WEIGHT Kg
				FLOODED	PRESSURISED To 0.7 BAR		
22	22	200	300	2000	3000	3	10
33	33	200	300	2000	3000	3	10

### ORDERING CODE

**FM - 33 - 1 - 1**

Type
Displacement
22 = 22 cc/rev
33 = 33 cc/rev

Ports
1 = Rear Ports 1-5/16 UNO
2 = Side Ports 1 -1/16 UNO(33cc Only)
Shaft
1 = 7/8" Keyed
2 = 13 Tooth x 7/8 Spline

Part No.	DESCRIPTION
<b>FM-33-1-1</b>	KEYED SHAFT REAR PORTED
<b>FM-33-1-2</b>	KEYED SHAFT SIDE PORTED
<b>FM-33-2-1</b>	SPLINE SHAFT REAR PORTED
<b>FM-33-2-2</b>	SPLINE SHAFT SIDE PORTED